

## Rivet Nuts

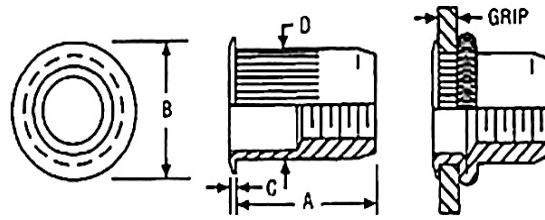

Steel Rivet Nut Zinc: NRIV020----X---Z1

Aluminum Rivet: NRIALM----X---

Thread Size	Steel Marson #	Aluminum Marson #	D		B		C		A		Grip Range		Hole Size		Drill Size
			Body Dia.	Head Dia.	Head Height	Body Length	Min	Max	Min	Max					
6-32	57110	57210	.189	.325	.032	.438	.010	.075	.189	.193	# 12				
8-32	57120	57220	.221	.357	.032	.438	.010	.075	.221	.226	# 2				
8-32	57121	57221	.221	.357	.032	.500	.075	.120	.221	.226	# 2				
10-24	57130	57230	.250	.406	.038	.531	.010	.080	.250	.254	1/4"				
10-24	57132	57232	.250	.406	.038	.594	.080	.130	.250	.254	1/4"				
10-32	57140	57240	.250	.406	.038	.531	.010	.080	.250	.254	1/4"				
10-32	57142	57242	.250	.406	.038	.594	.080	.130	.250	.254	1/4"				
1/4-20	57150	57250	.332	.475	.058	.625	.010	.080	.332	.338	Q				
1/4-20	57152	57252	.332	.475	.058	.687	.080	.140	.332	.338	Q				
1/4-20	57154	57254	.332	.475	.058	.750	.140	.200	.332	.338	Q				
5/16-18	57171	57271	.413	.665	.062	.750	.030	.125	.413	.423	Z				
5/16-18	57174	57274	.413	.665	.062	.875	.125	.200	.413	.423	Z				
3/8-16	57181	57281	.490	.781	.088	.844	.030	.115	.490	.500	12.5mm				
3/8-16	57184	57284	.490	.781	.088	.938	.115	.200	.490	.500	12.5mm				